

# *Village Directory* 2023

ACTON BURNELL, PITCHFORD, FRODESLEY, RUCKLEY AND LANGLEY





# NETLEY

BOARDING KENNELS AND CATTERY

Nice rural location  
 Heated kennels with outside runs  
 Friendly family run business

**Also offering doggy daycare**

NETLEY KENNELS AND CATTERY  
 Lower Netley Farm, Dorrington, Shrewsbury SY5 7JY  
 Mobile 07803240207 • Landline 01743 623176

Welcome to the fifth edition of the Parish Directory for the communities of Acton Burnell, Pitchford, Frodesley, Ruckley and Langley.

This publication is funded by local advertising and compiled, produced and delivered by our team of volunteers. We try to include as much useful information as possible, but always welcome suggestions for ways in which we can improve. Please send any feedback (positive or otherwise!) to [villageviews@hotmail.com](mailto:villageviews@hotmail.com). Please note:

- All opening times given are correct as of 1st June 2023, but please check before travelling or making special arrangements, as opening hours and days may change at short notice.
- It is recommended that you always check with providers that their service or organisation meets your requirements.
- The inclusion of any business, service or organization in this Directory does not imply a recommendation or endorsement.
- Every effort has been made to ensure the accuracy of the information provided in this directory, but we do not accept any responsibility or liability for any errors that may have occurred.
- If you discover any mistakes, please contact us at the email address below, so that these can be corrected in future editions.

**The Editorial Team Email: [villageviews@hotmail.com](mailto:villageviews@hotmail.com)**

Chris Harrison | Karen Fisher | John Glover | Rachel Johnson | Lois Johnson

## CONTENTS

Welcome	3	Parish Map	16
Defibrillators	4	Shops and Post Offices	18
The Parish Council	5	Petrol Stations	18
Meet your Councillors	6	Pharmacies and Chemists	19
Policing and Safety	8	Pubs, Cafes and Restaurants	20
Health and Medical Services	9	Takeaways	20
Local Medical Practices	10	Veterinary Practices	21
Local Hospitals	11	Boarding Kennels and Catteries	21
Rubbish Collection and Recycling	12	Pitchford Village Hall	22
Bus Routes and Times	13	Schools and Colleges	24
Places of Worship	14	Local Attractions	26
Libraries	15	Help and Support	28

Information provided in this directory is intended to provide a guide to local organisations and services available to residents in the parish of Acton Burnell. The information contained is not exhaustive, and the listing of any group, club, organisation, business or establishment should not be taken as an endorsement or recommendation. While every effort has been made to ensure that the information included is accurate, users of this directory should not rely on the information provided and must make their own enquiries, inspections and assessments as to suitability and quality of services.

## DEFIBRILLATORS

Defibrillators for public use can be found at:

- **Acton Burnell:** on the side wall of the Post Office
- **Frodesley:** in the telephone kiosk at the Frodesley crossroads
- **Pitchford:** at the village hall, to the left of the main door
- **Ruckley:** on the front wall of Ruckley Home Farm

The defibrillator can be used by any member of the public. It can be used if someone is unconscious and you think, or suspect, that they may have had a cardiac arrest or heart attack.

If you think someone has had a heart attack:

1. Before you do anything else - dial **999** to alert the ambulance service.
2. Go immediately to the defibrillator and unlock the cabinet door by entering the code which you will find on the door of the cabinet.
3. Picture guides and verbal instructions will lead you through the process to follow.
4. The defibrillator runs checks on the patient's heart rhythm, and only allows you to go ahead if defibrillation is needed – the defibrillator will not work on someone who is not in cardiac arrest.
5. The defibrillator may also instruct you to carry out CPR (chest compressions). The unit gives clear instructions on how to do this

This information has been provided by the defibrillator suppliers and is meant for guidance only.

**IN THE EVENT OF AN EMERGENCY, ALWAYS FOLLOW THE INSTRUCTIONS PROVIDED BY THE DEFIBRILLATOR UNIT.**

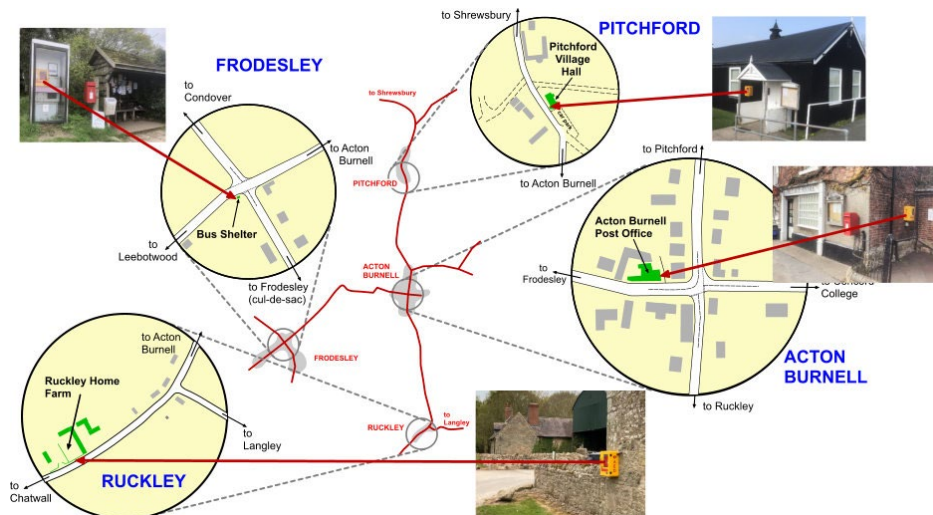

## THE PARISH COUNCIL

### A QUICK GUIDE

- Covers Acton Burnell (including Acton Pigott), Frodesley, Pitchford, Ruckley & Langley.
- Has a range of responsibilities, including looking after community buildings, street lighting, bus shelters and traffic calming measures.
- Comments on local planning applications to Shropshire Council (but does not make decisions).
- Responsible for producing a 'Community Led Plan' every 3-5 years, which identifies the main areas of concerns of the local community and helps to guide future improvements, developments and financial investment.
- Funded by the County Council (via Council Tax). It also receives annual 'Community Benefit' payments from local solar power farms. This money is used to support local groups and projects.
- Parish Councillors are unpaid. They must either: live in (or within three miles of) the parish; or work there; or own property/land there.
- Councillors serve for 4 years, after which they must stand for re-election. If only one candidate comes forward, then no election takes place. If there are no candidates for a vacancy, then the Parish Council can co-opt someone to fill the place.
- Parish Council meetings take place once every two months. See the Parish Council website ([www.actonburnellparishcouncil.org.uk](http://www.actonburnellparishcouncil.org.uk)) for details of upcoming meetings and minutes of previous meetings.
- Members of the public can attend any Parish Council meeting, but may be asked to leave if the Council is discussing confidential matters.
- To contact the Parish Council, please call or email one of the councillors (contact details are shown on the 'Your Parish Councillors' page).
- To speak on any subject at a PC meeting or to request an item be discussed at one, please email the Parish Clerk, Anna Morris, beforehand, on [clerk@actonburnellparishcouncil.org.uk](mailto:clerk@actonburnellparishcouncil.org.uk) or call her on **07842 324809**.
- You can also write to the Parish Council c/o 2 Frodesley House Farm Barns, Frodesley, Shrewsbury, Shropshire SY5 7HD.

## MEET YOUR COUNCILLORS



**Paul Harrison** Chair of the Parish Council

[paulharrison@actonburnellparishcouncil.org.uk](mailto:paulharrison@actonburnellparishcouncil.org.uk) | 01694 731120

I am a retired mechanical engineer and worked in the oil industry since leaving school in Kidderminster. Following UK and overseas postings we moved to Shropshire in 1992 and set up our own business and smallholding. After a period in France we returned to Shropshire in 2012 and were lucky to find a home in Acton Burnell. Chris and I have two children (son and daughter) and two grandchildren. My interests are wildlife, dog walking, photography and keeping up with current affairs. I am committed to preserving and developing our community and improving the quality of life for local residents.



**John Long**

[johnlong@actonburnellparishcouncil.org.uk](mailto:johnlong@actonburnellparishcouncil.org.uk) | 01694 731517

After 25 years travelling the world with the RAF, I moved into business and, finally, set up my own minuscule management consultancy. Jo and I, together with our two daughters, moved to Shropshire over 20 years ago and have no intention of ever moving away. Apart from being on the Parish Council, I'm also a member of the Shropshire Hills AONB's management board and volunteer with the NT at Attingham Park and as a guide at Pitchford Hall.



**Gareth Ball**

[rgball@actonburnellparishcouncil.org.uk](mailto:rgball@actonburnellparishcouncil.org.uk) | 01694 731636

I have lived locally for over 40 years, teaching in Telford and latterly Bridgnorth until retirement. I have always participated in community affairs of all kinds, also serving on a number of governing bodies of local schools including Acton Burnell before its closure. In addition I am a Church Warden at St Mary's Acton Burnell. I feel strongly that we all need to be involved with our communities to ensure a healthy future and I continually seek to promote this principle as a parish councillor.



**Carmen Culliss**

[carmenculliss@actonburnellparishcouncil.org.uk](mailto:carmenculliss@actonburnellparishcouncil.org.uk) | 01694 731679

I have lived in the village of Frodesley for the past 35 years with my husband Stuart and now grown up children (two children and 5 grandchildren). My interests include walking in our beautiful countryside we are lucky to live in and I am also a school governor at Church Stretton school and a trustee of the south Shropshire Academy trust. I enjoy being an active member of our community and supporting our schools and parish council.



**Graham Davies**

[grahamdavies@actonburnellparishcouncil.org.uk](mailto:grahamdavies@actonburnellparishcouncil.org.uk) | 01694 731237

I was born in Frodesley village in 1950 and have lived and farmed here ever since. Kathryn and I married 40 years ago and have two daughters, Jaci and Clare, who are both married to farmers, and we have four grandchildren. On our farm we have beef cattle and sheep. For many years I have been a churchwarden at St. Mark's Church and together with John Davies Snr. have looked after the Frodesley village borehole supply. I am proud of the history of Frodesley and proud to be a part of it.

## MEET YOUR COUNCILLORS



**Keith Faulkner**

[keithfaulkner@actonburnellparishcouncil.org.uk](mailto:keithfaulkner@actonburnellparishcouncil.org.uk) | 01694 731363

I have lived at Langley all my life, where we have a mixed farm of arable, beef and sheep. I am married to my wife Jill and we have two children. As well as being a member of the Parish Council I am also Chairman of the West Midlands Area for the Tenant Farmers Association, and believe that if you want to see changes made you need to take part and engage with people.



**Alan Hotchkiss**

[alan.hotchkiss@actonburnellparishcouncil.org.uk](mailto:alan.hotchkiss@actonburnellparishcouncil.org.uk) | 07958 319474

I have had the pleasure of living in Pitchford for most of my life, I am married with two sons and have been self employed as a Garage Proprietor for thirty years. My interests are motorsports. I raced cars for over twenty years and I am currently competing in classic motorcycle trials. I also throw in the occasional round of golf. I do not waste time worrying about things that are outside of my control but I will endeavour to get involved with all matters arising concerning the stability of Pitchford and surrounding areas.



**Tracy Johnson**

[tracyjohnson@actonburnellparishcouncil.org.uk](mailto:tracyjohnson@actonburnellparishcouncil.org.uk) | 07974 952645

I have lived in this area all my life as my family farmed in Pitchford and when I married Paul in 1993 we made our home here with our two boys. I have always worked in administration and events including jobs with the Shropshire Star, the RTITB, and Shropshire Young Farmers' as County Administrator. I now run a holiday let business and involved in events management at Pitchford Hall. I am a keen horse rider, competing at British Dressage and Riding Club competitions. Pitchford and the surrounding area is at the heart of my life and I wish to ensure that our beautiful area is not spoilt and that our rural voices are heard.



**Robert Morgan**

[robertmorgan@actonburnellparishcouncil.org.uk](mailto:robertmorgan@actonburnellparishcouncil.org.uk) | 01694 731358

I have lived at Home Farm, Acton Burnell all my life and my family have farmed at Home Farm for the last 100 years. I am the third generation to see how the village has altered over the years. I have been a part of Acton Burnell Parish Council for a number of years and happy to help. My interest are sports, motorsport and shooting.



### SHROPSHIRE COUNCILLOR FOR WARD OF BURNELL

**Dan Morris** [dan.morris@shropshire.gov.uk](mailto:dan.morris@shropshire.gov.uk) | 07902 408400

I live on the family beef farm in Church Pulverbatch with my wife Iona and three children, and have been there for most of my life. I was first elected to Shropshire Council for our ward of Burnell in May 2017 and re-elected in May 2021. My main goal as Shropshire Councillor for Burnell is to ensure that rural communities like ours get their fair share of council funding and services. Outside of farming and being a Councillor, I am a school governor and you can find me either playing cricket or acting as a taxi service for my children!

## POLICING AND SAFETY

### EMERGENCY SERVICES

For all emergencies, and to report a crime taking place, please call **999**. For non emergencies, please call **101**, or use the 'contact us' form at [www.westmercia.police.uk/a/your-area/local-policing-team-contact/contact-your-local-policing-team/](http://www.westmercia.police.uk/a/your-area/local-policing-team-contact/contact-your-local-policing-team/)

### POLICE

Pitchford, Ruckley and Langley, Frodesley and Acton Burnell are covered by the Shrewsbury Rural East Neighbourhood Team. They can be contacted regarding local incidents or concerns by calling **101** or emailing [shrewsburyre.snt@westmercia.police.uk](mailto:shrewsburyre.snt@westmercia.police.uk).

The Safer Neighbourhood Team (SNT) works to identify, tackle and solve local issues, including day-to-day crime and anti-social behaviour. The SNT members for the Burnell area are Police Constable Support Office (PCSO) Lynn Birch; PCSO Stuart Roberts; Inspector Nicola Roberts; Inspector Ben Tanfield and Constable Simon Lewis. PCSO Lynn Birch has particular responsibility for Burnell Parish and can be contacted by phone on **07890 545343**.

Our nearest police station is at Clive Road, Monkmoor, Shrewsbury SY2 5RW, which is open on Monday to Saturday from *8.00am to 6.30pm* and on Sunday from *10.00am to 4.00pm*.

The West Mercia Police website ([www.westmercia.police.uk/crime-and-safety](http://www.westmercia.police.uk/crime-and-safety)) has information leaflets to download on a wide range of issues, from dealing with cold calling and distraction crimes, online safety, and domestic violence to preventing farm theft and poaching. Follow the links to find information to help keep you safe.

### USEFUL NUMBERS

To report concerns about a child's safety to Shropshire Council:  
**0345 678 9021 (0345 678 9040** outside office hours)

To report concerns about a vulnerable adult to Shropshire Council:  
**0345 678 9044 (0345 678 9040** outside office hours)

For people at risk of homelessness: **0345 678 9005**

To report antisocial behaviour: **0345 678 9020**

Crimestoppers (to report crime anonymously): **0800 555111**

Domestic Violence helpline (24 hours): **0808 2000 247**

## HEALTH AND MEDICAL SERVICES

### EMERGENCY SERVICES

Emergency services: **999**

Call **999** if you are experiencing a life-threatening emergency. This includes signs of a heart attack or stroke, loss of consciousness, sudden confusion, a suicide attempt, severe breathing difficulties or choking, heavy bleeding that cannot be stopped, injuries as a result of a serious accident or assault, a prolonged seizure (or fit), severe burns or scalds, or a severe allergic reaction. If you are experiencing any of these you can also choose to go direct to the Accident and Emergency Department of your nearest hospital if you can do so safely and quickly. A&E departments can be found at the Royal Shrewsbury Hospital and the Princess Royal Hospital in Telford.

For urgent medical concerns which cannot wait until you can contact your own GP, call **111** or go to **111.nhs.uk**. You will receive advice on what action you need to take for your symptoms, injury or dental problem. If they decide you need to go to A&E, an ambulance will be called for you.

Urgent Treatment Centres can also help with things like broken bones, sprains, stomach pain, vomiting and diarrhoea, high temperatures and mental health crises. Urgent Treatment Centres are available at both the Royal Shrewsbury Hospital and the Princess Royal Hospital, and are open from *9.00am to 9.00pm*.

Minor Injury Centres can help deal with things like animal bites, cuts, minor burns and scalds, bruises and sprains, and some broken bones. The service is available at Bridgnorth Community Hospital from *8.00am to 9.30pm*, and at Ludlow Community Hospital from *8.00am to 8.00pm*, but please note that these centres do not have an x-ray service at weekends.

## LOCAL MEDICAL PRACTICES

Local medical practices all request that patients always telephone or use their on-line Patient Access system to make an appointment. Practices also now offer an 'eConsult' service to enable patients to get non-urgent advice and information from their GP. Details are available on the practice websites.

### THE BEECHES MEDICAL PRACTICE (Bayston Hill and Dorrington)

#### Bayston Hill Surgery

1 Beeches Road, Bayston Hill, Shrewsbury SY3 0PF

Telephone: **01743 874565**

Website: **[www.thebeechesmedicalpractice.co.uk](http://www.thebeechesmedicalpractice.co.uk)**

Opening times: Monday to Friday 8.30am to 6.00pm

#### Dorrington Surgery

The Maitlands, Dorrington, Shrewsbury SY5 7LD

Telephone: **01743 718486**

Website: **[www.thebeechesmedicalpractice.co.uk](http://www.thebeechesmedicalpractice.co.uk)**

Opening times: Monday, Tuesday, Thursday, Friday 8.30am to 1.00pm

Wednesday 8.30am to 1.00pm and 2.00pm to 6.00pm

### MUCH WENLOCK MEDICAL PRACTICE (Much Wenlock and Cressage)

#### Much Wenlock Surgery

Kingsway Lodge, King Street, Much Wenlock TF13 6BL

Telephone: **01952 726011**

Website: **[www.muchwenlockandcressagemp.co.uk](http://www.muchwenlockandcressagemp.co.uk)**

Opening times: Monday to Friday 8.30am to 6.00pm

#### Cressage Surgery

Clifton Lodge, Sheinton Road, Cressage SY5 6DH

Telephone: **01952 726011**

Website: **[www.muchwenlockandcressagemp.co.uk](http://www.muchwenlockandcressagemp.co.uk)**

Opening times: Monday to Friday 08.30am to 12.30pm and 2.00pm to 6.00pm

### CHURCH STRETTON MEDICAL PRACTICE

Easthope Road, Church Stretton SY6 6BL

Telephone: **01694 722127**

Website: **[www.churchstrettonmedicalpractice.co.uk](http://www.churchstrettonmedicalpractice.co.uk)**

Opening times: Monday to Friday 8.30am to 1.00pm and 2.00pm to 6.00pm

## LOCAL HOSPITALS

### VISITING PATIENTS IN SHREWSBURY AND TELFORD HOSPITALS

From January 2023, patients at both hospitals can have two visitors between the hours of 11.30am and 8pm, but visitors must confirm their visit with the ward beforehand.

Go to **[www.sath.nhs.uk/wards-services/az-wards/](http://www.sath.nhs.uk/wards-services/az-wards/)** to find contact details for individual wards. Special arrangements are in place for the children's ward, maternity ward and for patients receiving end of life care, or requiring support. Please see **[www.sath.nhs.uk/patients-visitors/visiting-a-patient/](http://www.sath.nhs.uk/patients-visitors/visiting-a-patient/)** for more information.

### ROYAL SHREWSBURY HOSPITAL

Mytton Oak Rd, Shrewsbury, SY3 8XQ | **01743 261000** | **[www.sath.nhs.uk](http://www.sath.nhs.uk)**

#### Bus routes from Shrewsbury Bus Station

No. 74 Shrewsbury-Ford

No. 553 Shrewsbury-Bishop's Castle via Hanwood

No. 558 Shrewsbury-Montgomery via Chirbury, Worthen and Yockleton

No. X75 Shrewsbury-Rhayadar via Ford

#### Travelling by car

The Royal Shrewsbury Hospital is conveniently located near the A5-B4386 junction on the west of Shrewsbury. From this roundabout follow signs to Shrewsbury and the Royal Shrewsbury Hospital. The hospital is located 0.8 miles ahead on your left via a small roundabout.

### THE PRINCESS ROYAL HOSPITAL

Apley Castle, Apley, Telford TF1 6TF | **01952 641222** | **[www.sath.nhs.uk](http://www.sath.nhs.uk)**

#### Public transport

No. X4 Nine return journeys per day between Shrewsbury Bus Station and Wellington Bus Station taking 25 minutes.

No. X5 Ten return journeys per day between Shrewsbury Bus Station and Telford Bus Station taking 30 minutes.

No. 15 Telford to Arleston and No. 16 Telford to High Ercall both stop at The Princess Royal.

#### Travelling by car

The hospital is signposted from the A5223.

**Car parking charges** apply at both hospitals. The first 20 minutes is free; up to 2 hours will cost £3.50; up to 3 hours £4.50; up to 4 hours £5.50; up to 5 hours £6.50; and up to 24 hours £8.50. Payment can be made by cash or credit card, or online on the day of the visit at **[www.groupnexus.co.uk/shrewsbury-parking-payment](http://www.groupnexus.co.uk/shrewsbury-parking-payment)**.

Concessions are available for patients receiving frequent or long term care, and parking is free for patients receiving renal dialysis, receiving treatment in the O'Connor Oncology Unit, for people visiting in connection with a bereavement and for parents of children staying in hospital overnight. Registered disabled persons with a blue badge may park for free but you need to report to the Car Park Attendants who will register your vehicle details on their system.

If you need to unexpectedly leave your car for more than 24 hours, please speak to a member of staff to avoid additional charges.

## RUBBISH COLLECTION AND RECYCLING

Kerbside collection is on Fridays (there may be a change of day around bank holidays). General household rubbish (darker coloured or grey wheelie bin) is collected once a fortnight and recycling boxes and garden waste (green bins) are collected on alternate fortnights.

Go to [www.shropshire.gov.uk/recycling-and-rubbish/when-is-my-bin-collected/](http://www.shropshire.gov.uk/recycling-and-rubbish/when-is-my-bin-collected/) to find a collection calendar.

Cans, plastics and glass can all be placed in one box, and cardboard and paper placed in the blue bag. Garden and food waste (including fruit, veg peelings, coffee grounds, tea bags and meat, fish and cheese waste) should be placed in the green wheelie bin. Batteries can be placed in a clear plastic bag and put out next to your recycling boxes on recycling day.

The darker coloured or grey wheelie bin is for all items not included above and for all items which cannot be recycled.

Additional or replacement bins and blue cardboard bags can be obtained by calling **0345 678 9007**.

Larger items or items not included in the list above (such as unused paint, oils, metal waste etc) can be taken to Shrewsbury Household Recycling Centre Vanguard Way, Battlefield Enterprise Park, Shrewsbury SY1 3TG. The centre is open daily (except Christmas Day, Boxing Day and New Year's Day) from *9.00am to 5.00pm*. It is open to all householders, but if you are visiting the site with a pick-up truck, van or trailer, you may need to apply for a permit. Bulky items can be collected for a fee by telephoning **0345 678 9007**.

Some items (such as furniture) can be donated to a local recycling charity or scheme. Please note that since Covid there may be limitations on what can be accepted, and you may need to book an appointment before dropping off any items. Please call the charity or scheme to check in advance.

### Some local schemes include:

Shrewsbury Furniture Scheme: **01743 246668**

[www.shrewsburyfurniturescheme.com/contact-us](http://www.shrewsburyfurniturescheme.com/contact-us)

British Heart Foundation: **08082 500030**

[www.bhf.org.uk/shop/donating-goods/book-furniture-collection-near-me](http://www.bhf.org.uk/shop/donating-goods/book-furniture-collection-near-me)

Wrekin Reviive: **01743 588458** | [www.reviive.co.uk](http://www.reviive.co.uk)

Severn Hospice: **01743 211092**

[www.severnospice.org.uk/support-us/our-shops/furniture-store/](http://www.severnospice.org.uk/support-us/our-shops/furniture-store/)

Other charities may also be prepared to collect your good quality used items – please contact them direct to enquire.

You can also use the Freecycle and Freegle websites, and the Trash Nothing app to offer items free to local people or to find re-used things you need:

Freecycle: <https://groups.freecycle.org/group/ShrewsburyUK>

Freegle: [www.ilovefreegle.org](http://www.ilovefreegle.org)

## BUS ROUTES AND TIMES

Please note that these are subject to change, so if in doubt, please check before travelling by calling the service provider, Lakeside of Ellesmere, on **01743 297029** or emailing [mailbox@lakesidecoaches.co.uk](mailto:mailbox@lakesidecoaches.co.uk). The bus route serving our villages is the 540.

### WEEKDAY BUSES (term time only)

#### Cardington to Shrewsbury

Calling at:	Frodesley (opposite crossroads)	8.05am
	Acton Burnell (near Post Office)	8.09am
	Pitchford (opposite the Old Rectory)	8.12am
	Cantlop (opposite the crossroads)	8.15am
	Arrives at Shrewsbury Bus Station	8.35am

#### Shrewsbury to Cardington:

Leaves Shrewsbury Bus Station (Stand N)	4.30pm	
Calls at:	Cantlop (opposite the crossroads)	4.51pm
	Pitchford (opposite the Old Rectory)	4.55pm
	Acton Burnell (near Post Office)	4.59pm
	Frodesley (opposite crossroads)	5.03pm

### SATURDAY BUSES (no Sunday service)

#### Wall under Heywood to Shrewsbury:

Calling at:	Frodesley (opposite crossroads)	9.24am
	Acton Burnell (near Post Office)	9.28am
	Pitchford (opposite the Old Rectory)	9.31am
	Cantlop (opposite the crossroads)	9.34am
	Arrives at Shrewsbury Bus Station	9.56am

#### Shrewsbury to Cardington:

Leaves Shrewsbury Bus Station (Stand N)	12 noon	
Calling at:	Cantlop (opposite the crossroads)	12.24pm
	Pitchford (opposite the Old Rectory)	12.28pm
	Acton Burnell (near Post Office)	12.32pm
	Frodesley (opposite crossroads)	12.36pm
	Arrives Cardington	12.55pm

## PLACES OF WORSHIP

This is a guide to some local places of worship and is not exhaustive.

### CHURCH OF ENGLAND

St Mary's, Acton Burnell, Shrewsbury SY5 7PE

St Mark's, Frodesley SY5 7GA

St Michael and All Angels, Pitchford SY5 7DN

### ROMAN CATHOLIC

Shrewsbury Cathedral, Town Walls,  
Shrewsbury SY1 1UE | **01743 290000**

St Winefride's Church, 187 Crowmere Rd,  
Shrewsbury SY2 5LA

Our Lady of Pity Church, 3 Meadow Cl,  
Shrewsbury SY1 4PU

St Milburga, Watling St North,  
Church Stretton SY6 7AR | **01694 658091**

### METHODIST

Belle Vue Methodist Church, Belle Vue Rd,  
Shrewsbury SY3 7NL | **01743 260939**

Methodist Centre, Lansdowne Rd,  
Bayston Hill SY3 OHZ | **01743 874923**

Methodist Church, Watling St South,  
Church Stretton SY6 7BG | **01588 674984**

Methodist Church, King St,  
Much Wenlock TF13 6BL | **01952 275844**

### BAPTIST

Shrewsbury Baptist Church, Crowmere Rd,  
Shrewsbury SY2 5JJ | **01743 232331**

### QUAKERS

Quaker Meeting House, Corporation Ln,  
Shrewsbury SY1 2NU

### JEHOVAH'S WITNESSES

Kingdom Hall, Crowmere Rd,  
Shrewsbury SY2 5QZ | **01743 361643**

### SEVENTH DAY ADVENTIST

35A Abbey Foregate, Shrewsbury SY2 6BL  
**07825 135143**

### CHURCH OF JESUS CHRIST OF LATTER DAY SAINTS (Mormon)

Mount Pleasant Rd, Shrewsbury SY1 3HX  
**07800 614469**

### ISLAM

Shrewsbury Muslim Centre, 2 Preston St,  
Shrewsbury SY2 5NY | **01743 296140**

Shropshire Islamic Foundation,  
88-90 King St, Wellington, Telford TF1 1NZ  
**07814 611332**

Craven Arms Islamic Centre, Noor House,  
Newton St, Craven Arms SY7 9PQ  
**01588 676319**

### HINDUISM

Shri Radha Krishna Temple, 20-22 Bank Rd,  
Telford TF4 2AZ | **07378 400427**

### SIKHISM

Guru Nanak Gurdwara, 1 Hadley Park Rd,  
Hadley, Telford TF1 6PW | **01952 411730**

Sangat Parchar Sabha Gurdwara  
Community Cohesion Centre,  
19a Stafford Rd, Telford TF2 6JN

### BUDDHISM

Shrewsbury Triratna Buddhist Centre,  
Castlefields, Queen St, Shrewsbury SY1 2JU

### JUDAISM

Stoke on Trent Synagogue, 100 London Rd,  
Newcastle under Lyme ST5 1LZ  
**01782 616417**

Solihull Synagogue, 3 Monastery Dr,  
Solihull B91 1DW | **01217 068736**

## LIBRARIES

Library membership is free to anyone who lives, works or studies in Shropshire. You can apply on-line at [www.shropshire.gov.uk/libraries/join-the-library/](http://www.shropshire.gov.uk/libraries/join-the-library/) or in person at one of the libraries. You will need to provide proof of your address.

Borrowing books is free, but there is a charge if you do not return your books on time (currently this is 25p per day, up to a total of £5 per book). There is no charge for overdue children's books. There is a charge for borrowing DVDs, CDs and audiobooks. Library members can also use the on-line book catalogue at <https://libraries.shropshire.gov.uk/web/arena/welcome> to search for and reserve books.

Shropshire's 'Libraries from Home' service offers a wide range of resources, including online books, stories and activities for children and young people, and links to useful sites allowing access to a large number of organisations and charities. You can find more information at [www.shropshire.gov.uk/libraries/libraries-from-home/](http://www.shropshire.gov.uk/libraries/libraries-from-home/).

There are libraries at:

**Shrewsbury** (Castle Gates)

Telephone: **01743 255308**

**Bayston Hill** (Lythwood Road)

Telephone: **01743 872412**

**Much Wenlock** (The Corn Exchange, High Street)

Telephone: **01952 728293**

**Church Stretton** (Church Street)

Telephone: **01694 722535**













For details of opening hours, please call, or go to [www.shropshire.gov.uk/libraries/find-a-library/](http://www.shropshire.gov.uk/libraries/find-a-library/).

The mobile library van calls at Acton Burnell every other Thursday (on the same week that the green bin is collected), and parks near the village shop for around 15 minutes, from 10.35am. From Acton Burnell, the van heads to Ruckley Hall Farm. For more information on the mobile library, please call **01743 255024**. Please note that we are on 'route 11'.



SERVICES AND FACILITIES IN AND AROUND ACTON BURNELL, FRODESLEY, PITCHFORD, RUCKLEY & LANGLEY PARISH

KEY

-  PUBLIC HOUSE
-  TAKEAWAY FOOD
-  CHURCH (MEMBER OF THE BENEFICE OF CONDOVER)
-  SHOP
-  SCHOOL
-  GARDEN CENTRE
-  OTHER FACILITY
-  PETROL STATION
-  OTHER SERVICES
-  MEDICAL
-  ENGLISH HERITAGE
-  NATIONAL TRUST
-  PARISH OF ACTON BURNELL, FRODESLEY, PITCHFORD AND RUCKLEY & LANGLEY

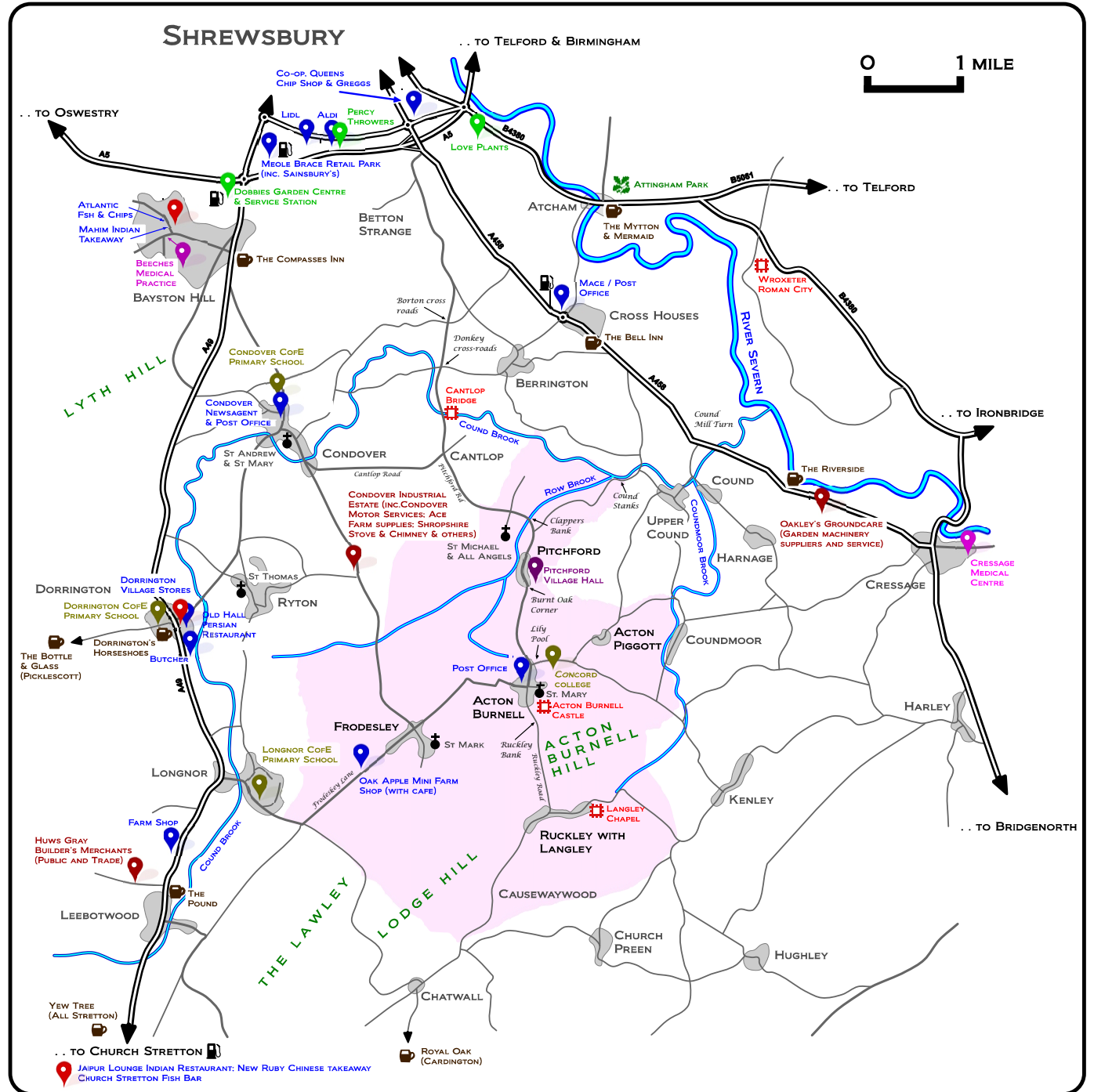

## SHOPS AND POST OFFICES

Please note that opening hours and days for some shops and post offices may be subject to change at short notice.

### Acton Burnell Stores and Post Office

Monday, Tuesday, Thursday, Friday:  
9.00am to 1.00pm and 2.00pm to 5.00pm  
Wednesday, Saturday and Sunday:  
Closed all day

### Conover Newsagent and Post Office

Monday to Friday: 9.00am to 5.15pm  
Saturday and Sunday: Closed all day

### Dorrington Village Stores

Monday, Tuesday, Wednesday,  
Thursday, Friday: 6.30am to 7.30pm  
Saturday: 7.30am to 6.00pm  
Sunday: 7.30 to 12 noon

### Oak Apple Farm Shop

Oak Tree Farm, Frodesley  
Monday to Friday: 9.00am to 5.00pm  
Sunday: 10.00am to 6pm  
*Tea and cake also on sale to enjoy in the farm shop garden.*

### Sainsbury's

Meole Brace Retail Park, Hereford Road,  
Shrewsbury, SY3 9NB  
Monday to Friday: 7.00am to 11.00pm  
Saturday: 7.00am to 10.00pm  
Sunday: 10.00am to 4.00pm

### Sainsbury's Local

Abbey Foregate, Shrewsbury  
Every day: 7.00am to 11.00pm

### ASDA

Old Potts Way, Shrewsbury, SY3 7ET  
Monday to Saturday: 7.30am to 10.00pm  
Sunday: 10.00am to 4.00pm

### CO-OP

Wenlock Road, Shrewsbury, SY2 6LG  
Every day: 7.00am to 10.00pm

### LIDL

Oteley Road, Shrewsbury, SY2 6ST  
Monday to Saturday: 8.00am to 10.00pm  
Sunday: 10.00am to 4.00pm

### ALDI

Oteley Road, Maxwell Drive,  
Shrewsbury, SY2 6QZ  
Monday to Saturday: 8.00am to 10.00pm  
Sunday: 10.00am to 4.00pm

## PHARMACIES AND CHEMISTS

Please note that some local medical practices are able to dispense prescriptions for their patients – please contact your local surgery for more information. Listed below are the chemist shops and pharmacies nearest to our community. Please telephone the chemists listed to check opening hours.

The NHS website also has a search option to allow you to find details of local pharmacies, including contact details and opening hours. Please go to [www.nhs.uk/service-search/pharmacy/find-a-pharmacy](http://www.nhs.uk/service-search/pharmacy/find-a-pharmacy)

### SHREWSBURY

#### Rowlands Pharmacy

7 Lansdowne Road, Bayston Hill,  
Shrewsbury SY3 OHT | **01743 872154**

#### Boots Pharmacies

Meole Brace Retail Park, Hereford Rd,  
Shrewsbury SY3 9NB | **01743 236973**

#### Lloyds Pharmacy, Sainsbury's

Meole Brace Retail Park,  
Hereford Road, Shrewsbury, SY3 9NB  
**01743 365536**

#### Asda Pharmacy

Old Potts Way, Shrewsbury SY3 7ET  
**01743 276810**

#### Lunts Pharmacy

1 Hereford Road, Shrewsbury SY3 7QT  
**01743 351918**

### MUCH WENLOCK

#### Wenlock Pharmacy

14 High Street, Much Wenlock TF13 6AA  
**01952 727253**

### CHURCH STRETTON

#### Hillside Pharmacy

18 Sandford Avenue,  
Church Stretton SY6 6BW  
**01694 722799**

#### Rowlands Pharmacy

40 Sandford Avenue  
Church Stretton SY6 6BH  
**01694 722806**

## PETROL STATIONS

### Thieves Lane (Shell)

Thieves Lane, Shrewsbury SY2 6GF  
*Open 24 hours every day*

### Wheatland Services (Shell)

Bridgnorth Road,  
Much Wenlock TF13 6AG  
Open every day: 6.00am to 10.00pm

### EG Shrewsbury (Esso)

Hereford Road/A5 (Dobbie's services),  
Shrewsbury, SY3 ODA  
*Open 24 hours every day*

### Sainsbury's

Meole Brace Retail Park, Hereford Rd,  
Shrewsbury SY3 9NB  
Monday to Friday: 5.00am to 11.00pm  
Saturday: 5.00am to 10.00pm  
Sunday: 7.00am to 10.00pm

### Asda

Old Potts Way, Shrewsbury, SY3 7ET  
Monday to Saturday: 7.30am to 10.00pm  
Sunday: 10.00am to 4.00pm

## PUBS, CAFES AND RESTAURANTS

**The Compasses Inn** Bayston Hill  
01743 632587  
[www.facebook.com/compassesinn/](http://www.facebook.com/compassesinn/)

**The Mytton and Mermaid** Atcham  
01743 293600  
[www.brunningandprice.co.uk/myttonandmermaid](http://www.brunningandprice.co.uk/myttonandmermaid)

**The Bell Inn** Cross Houses  
Open Tuesday to Saturday and Sunday lunchtime  
01743 761264  
[www.facebook.com/thebellinncrosshouses/](http://www.facebook.com/thebellinncrosshouses/)

**The Riverside Inn** Cound  
01743 296613  
[www.chefandbrewer.com/pubs/shropshire/riverside-inn/](http://www.chefandbrewer.com/pubs/shropshire/riverside-inn/)

**The Bottle and Glass** Picklescott  
Open Wednesday to Sunday  
01694 751252  
[www.bottleandglass.co.uk](http://www.bottleandglass.co.uk)

**Horseshoes** Dorrington  
01743 718305  
[www.dorringtonhorseshoes.co.uk](http://www.dorringtonhorseshoes.co.uk)

**The Pound** Leebotwood  
01694 751477  
[www.thepoundinnpub.co.uk](http://www.thepoundinnpub.co.uk)

**The Yew Tree** All Stretton  
01694 328953  
[www.yewtree-allstretton.co.uk](http://www.yewtree-allstretton.co.uk)

**The Royal Oak** Cardington  
01694 771266 | [www.at-the-oak.com](http://www.at-the-oak.com)

**Old Hall Persian Restaurant** Dorrington  
01743 719100 | [www.oldhallpersian.co.uk](http://www.oldhallpersian.co.uk)

**The Fox Inn Ryton**  
Currently closed, but hoping to re-open as a community venture.

## TAKEAWAYS

Included are details of some of the closest takeaway restaurants, but please note that many others are available in Shrewsbury.

**Old Hall Persian Restaurant**  
Dorrington, SY5 7JD  
01743 719100 | [www.oldhallpersian.co.uk](http://www.oldhallpersian.co.uk)

**Tim Tim Chinese Takeaway**  
33 Monkmoor Road, Shrewsbury, SY2 5AH  
01743 357045

**Eatwise Chinese Takeaway**  
119 Longden Coleham, Shrewsbury, SY3 7DU  
01743 236966

**Shalimar Indian Takeaway**  
131 Hereford Road, Shrewsbury, SY3 7QZ  
01743 231231  
[www.facebook.com/shalimarshrewsbury](http://www.facebook.com/shalimarshrewsbury)

**Pizza Hut**  
Meole Brace Retail Park Shrewsbury, SY3 6NB  
01743 231887 | [www.pizzahut.co.uk](http://www.pizzahut.co.uk)

**MacDonald's**  
Meole Brace Retail Park, Shrewsbury, SY3 6NB  
01743 353259 | [www.mcdonalds.com](http://www.mcdonalds.com)

**Shire Fryer**  
3 London Road, Shrewsbury SY2 6NN  
01743 641331 | [www.theshirefryer.co.uk](http://www.theshirefryer.co.uk)

**Queen's Fish and Chips**  
Shrewsbury Business Park, Shrewsbury, SY2 6FG  
01743 341186  
[www.queensfishandchips.co.uk](http://www.queensfishandchips.co.uk)

**Burger King**  
A5 Services (Dobbie's), Shrewsbury, SY3 0DA  
01743 588020 | [www.burgerking.co.uk](http://www.burgerking.co.uk)

**Mahim Indian Takeaway**  
9 Landsdowne Road, Bayston Hill, SY3 0HT  
01743 873434  
[www.mahimindiantakeaway.co.uk](http://www.mahimindiantakeaway.co.uk)

**Hong Kong City**  
10a Hereford Road, Shrewsbury, SY3 0DB  
01743 874553

**Jaipur Lounge**  
6 Sandford Ave, Church Stretton, SY6 6BW  
01694 724667 | [www.jaipurlounge.co.uk](http://www.jaipurlounge.co.uk)

## VETERINARY PRACTICES

**Abbey Veterinary Centre**  
16 Holywell St., Abbey Foregate,  
Shrewsbury SY2 5DB | 01743 232713

**Animal Health Centre**  
105 Longden Road, Shrewsbury SY3 9DZ  
01743 369999

**Animal Trust Not for Profit Vets**  
Coleham Head, Shrewsbury SY3 7BJ  
01743 296246

**Malthouse Surgery**  
1 Shrewsbury Road,  
Church Stretton SY6 6JA | 01743 791246

**Market Town Vet**  
Tilstock Crescent, Shrewsbury SY2 6HW  
01743 816288

**Medivet Sutton Farm**  
Unit 5, Maxfield Drive,  
Otley Road, Shrewsbury SY2 6QZ  
01743 352274

**Medivet 24 Hour**  
2 Longbow Close, Harlescott,  
Shrewsbury SY1 3GZ | 01743 403691

**Severn Edge Vets**  
Victoria Road, Much Wenlock TF13 6AH  
01952 726007  
6 The Square, Church Stretton SY6 6DA  
01694 722546

**Quarry Vets**  
Main Surgery, Brassey Road,  
Old Potts Way, Shrewsbury SY3 7FA  
01743 362556

## BOARDING KENNELS AND CATTERIES

**Lower Mill Boarding Kennels and Cattery**  
Pontesford  
[www.lowermillkennels.co.uk](http://www.lowermillkennels.co.uk)  
01743 790160

**Moorlands Cattery**  
The Moorlands, Conover SY5 7BS  
[www.moorlandscattery.co.uk](http://www.moorlandscattery.co.uk)  
07932 034341

**Netley Boarding Kennels and Cattery**  
Lower Netley Farm, Dorrington SY5 7JY  
[www.facebook.com/NetleyKennels/](http://www.facebook.com/NetleyKennels/)  
07803 240207

## PITCHFORD VILLAGE HALL



Pitchford Village Hall is a charitable organisation and the only social facility available to all within our parish. Hosting regular events, it is at the centre of our community. Located in the north of our area, it is available for hire for both public and private events.

- The Management Committee organise several events over the year. It hosts a 'Pub night' open to all in our parish and beyond on the second Friday of each month. Starting at 7.30pm we often have outside caterers offering food in addition to a well-stocked bar. This is probably the only regular event which allows everyone living in the area to meet socially and enjoy a cheap drink! It is well-attended and jovial and all are welcome including children and dogs!
- We run a photography competition with four stages, based on each of the four seasons. Regular 'Breakfast Butty' mornings on a number of Saturdays throughout the year along with an associated circular walk open to all and starting and ending at the Hall, is popular and very affordable.
- We run a Christmas Fayre held early each December along with other events such as Plant Fayres.
- The Committee also runs a monthly tote to raise funds towards the running costs of the Hall. This costs £12 per year and gives a chance of winning prizes of either £50, £25, £15 or £10 per month. All are welcome to join.

Various other fund-raising and community events also occur throughout the year and these can be viewed on our Facebook page ([pitchfordvillagehall](#)), our Instagram account ([@pitchfordvillagehall](#)) or via the Acton Burnell Community Facebook page. More importantly, it is available to anyone in the area to hire for their own use. Previous 'hires' have included children's parties, birthday parties, wakes, group meetings and other similar uses. Recent renovations have modernised the facility making it a superb location for private occasions. **It is your facility to use!** The costs are very competitive and are all inclusive.

### VILLAGE HALL LOCATION

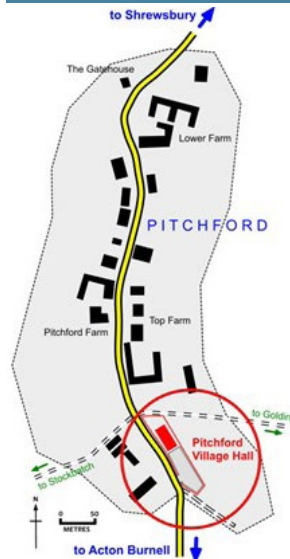

### HIRE COSTS

Meetings from £15.00  
Children's parties from £25  
Other events from £30

## PITCHFORD VILLAGE HALL

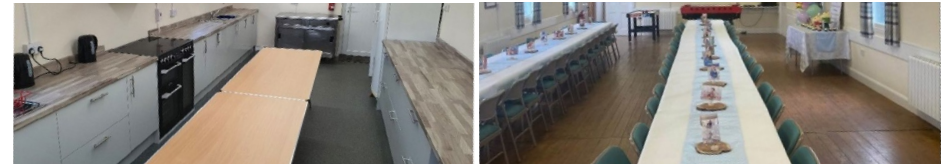

### FACILITIES:

- Large multi-use hall with tables and chairs, seating up to 100, or up to 150 non-seated.
- Recently upgraded modern kitchen area with cutlery, plates, glasses and cups, cooker, fridge, microwave, dishwasher and hot cabinet.
- New heating system installed 2021.
- Projector and screen with HiFi sound system for laptops allowing photos and videos to be played.
- Bluetooth receiver to allow you to bring and play your own music through our HiFi system.
- Toilets, including disabled facilities.
- Small outside area with picnic table laid to grass.
- Large car park.

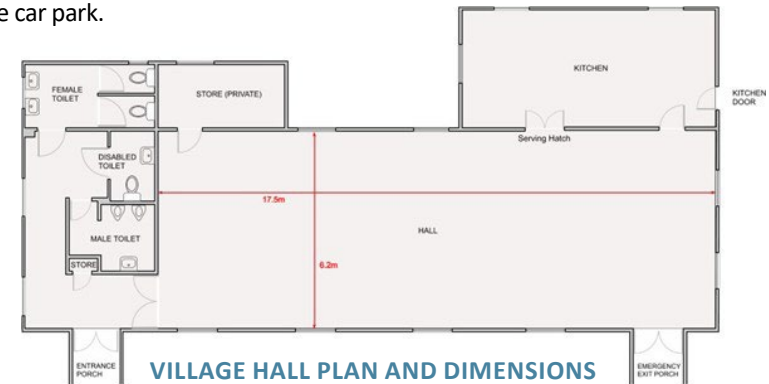

VILLAGE HALL PLAN AND DIMENSIONS

Contact details regarding joining the tote, bookings and indeed any other queries, are as follows:

**Mike Price** (Chairman, Pitchford Village Hall Management Committee):  
Email: [price622@btinternet.com](mailto:price622@btinternet.com) | mobile: **07740 067955**

**Chris Jones** (Secretary, Pitchford Village Hall Management Committee):  
Email: [csjay@btinternet.com](mailto:csjay@btinternet.com) | mobile: **07538 744807**

**Jeanette Reaney** (Tote Organiser, Pitchford Village Hall Management Committee):  
Email: [jeanettereaney@hotmail.com](mailto:jeanettereaney@hotmail.com) | mobile: **07971 780963**

While the facility is run by volunteers, we are always looking for new folk to help us by either spreading the load, or by refreshing us with new ideas and innovations. If you can spare a bit of time and wish to contribute to your community, please do contact one of the above for an informal, non-committal chat! We don't bite and are genuinely welcoming and friendly and appreciative of whatever time you can give!

## SCHOOLS AND COLLEGES

The schools and colleges closest to our community are listed below. For more information on state schools and colleges further afield, please go to [www.shropshire.gov.uk/schools-and-education/schools-and-term-dates/shropshire-council-maintained-schools-and-academies/](http://www.shropshire.gov.uk/schools-and-education/schools-and-term-dates/shropshire-council-maintained-schools-and-academies/) and click on 'Schools List.' A link to information on independent schools and colleges can be found on the same webpage by clicking on 'Independent schools in Shropshire'.

### NURSERY SCHOOLS

#### Little Owls Longnor CE Primary School

Frodesley Road, Longnor SY5 7PP  
For ages 3 to 4; term time only  
Telephone: **01743 718493**

#### Church Preen Pre-School

Church Preen Village Hall, Church Preen SY6 7LH  
For ages 2 to school age. Open Monday, Tuesday and Wednesday only, *9.00am to 3.00pm* – maximum of 20 children per session. Closed during school summer holidays. Pre-school children are now able to attend Church Preen Primary school's before and after school provision.  
Telephone: **01694 771797**

#### Condover Pre-School

Condover, SY5 7AA  
For ages 2 to 4; term time only, *9.00am to 3.30pm* (early bird service available from *8.45am*)  
Telephone: **01743 873518**

### PRIMARY SCHOOLS

#### Longnor CE School

Frodesley Road, Longnor SY5 7PP  
Telephone: **01743 718493**  
Website: [www.longnorschool.org.uk](http://www.longnorschool.org.uk)  
Headteacher: Mrs L Edgerton ([head@longnorschool.co.uk](mailto:head@longnorschool.co.uk))  
Administrator: Mrs R Reynolds ([admin@longnorschool.co.uk](mailto:admin@longnorschool.co.uk))

#### Church Preen Primary School

Church Preen SY6 7LH  
Telephone: **01694 771359**  
Website: [www.churchpreenschool.org.uk](http://www.churchpreenschool.org.uk)  
Email: [admin@churchpreenschool.co.uk](mailto:admin@churchpreenschool.co.uk)  
Headteacher: Mr Dave Tinker  
Acting Headteacher: Ms Marilyn Hunt

#### Condover CE Primary School

Condover SY5 7AA  
Telephone: **01743 872108**  
Email: [admin@condoverschool.co.uk](mailto:admin@condoverschool.co.uk)  
Website: [www.condoverschool.co.uk](http://www.condoverschool.co.uk)  
Headteacher: Mrs Kerrie Lewis

#### St Edward's CE Primary School

Church Road, Dorrington SY5 7JL  
Telephone: **01743 718462**  
Email: [admin@stedwardsprimaryschool.co.uk](mailto:admin@stedwardsprimaryschool.co.uk)  
Website: [www.stedwards.shropshire.sch.uk](http://www.stedwards.shropshire.sch.uk)  
Executive Headteacher: Mrs Kerrie Lewis

## SCHOOLS AND COLLEGES

### SECONDARY SCHOOLS AND COLLEGES

#### William Brookes School and Sixth Form

Farley Road, Much Wenlock TF13 6NB  
For ages 11 to 18 years.  
Telephone: **01952 728900**  
Email: [info@williambrookes.com](mailto:info@williambrookes.com)  
Website: [www.williambrookes.com](http://www.williambrookes.com)  
Headteacher: Mr Stephen Richards

#### Church Stretton School

63A Shrewsbury Road, Church Stretton SY6 6EX  
For ages 11 to 16 years.  
Telephone: **01694 722209**  
[www.churchstretton.shropshire.sch.uk](http://www.churchstretton.shropshire.sch.uk)  
Headteacher: Mr J Parr

#### Concord College

Acton Burnell Hall, Acton Burnell SY5 7PF  
International independent co-educational college for ages 13-19. Boarding and day pupils welcomed. Means-tested bursaries available to support gifted local students.  
Telephone: **01694 731631**  
Email: [enquiries@concordcollege.org.uk](mailto:enquiries@concordcollege.org.uk)  
Website: [www.concordcollegeuk.com](http://www.concordcollegeuk.com)  
Principal: Dr Michael Truss

### POST-16 EDUCATION

#### Shrewsbury Colleges Group

London Road Campus **01743 342342**  
English and Welsh Bridge Campus, Telephone: **01743 235491**  
Email: [info@scg.ac.uk](mailto:info@scg.ac.uk)  
Website: [www.scg.ac.uk](http://www.scg.ac.uk)  
Principal & CEO: Mr James Staniforth

## LOCAL ATTRACTIONS

### ACTON BURNELL CASTLE

In the heart of Acton Burnell, the remains of this 13th century sandstone castle are free to visit and enjoy. Also check out the neighbouring St Mary's Church, also constructed in the 13th century, which contains fascinating memorials to local dignitaries, including a portrayal of Sir Richard Lee as a knight with his wife beside him and his 3 sons and 9 daughters around him. Follow signs for Acton Burnell Castle from the village crossroads. Parking available.

### LANGLEY CHAPEL

Tucked away in Langley is a 14th century chapel set in a peaceful field, and featuring 17th century pews. Free to visit. Follow the road from Acton Burnell to Ruckley, turning left at the Langley Chapel sign. Limited parking.

### PITCHFORD HALL

Occasional tours and events are held at this Tudor country house at Pitchford, the grounds of which houses a picturesque treehouse where Queen Victoria once played. For details of events, please go to their Facebook page (search for Pitchford Hall).

### ATTINGHAM PARK

National Trust owned estate featuring a Regency mansion and 200 acres of parkland, including woods, open parkland, a walled garden and children's play field Resident herd of fallow deer. Dogs welcome on leads in grounds, and off lead in some designated areas. Go to [www.nationaltrust.org.uk/attingham-park](http://www.nationaltrust.org.uk/attingham-park) for more information and admission prices.

### ATTINGHAM FARM

Home Farm at Attingham welcomes visitors to their traditional farm. Open daily during the summer, there is a charge of £5 for adults, £4 for OAPs and children over 3. Tea room and refreshments available. Access from the B4380 at Atcham. Go to [www.homefarmattingham.co.uk](http://www.homefarmattingham.co.uk) for more information.

### CARDING MILL VALLEY AND THE LONG MYND

A National Trust area of wildlife-rich heathland, offering everything from gentle strolls to challenging hikes. Mountain biking allowed on some routes. Parking available, but please note that this can become very crowded on sunny weekends and bank holidays. Tearoom and toilets available. More information at [www.nationaltrust.org.uk/visit/shropshire-staffordshire/carding-mill-valley-and-the-long-mynd](http://www.nationaltrust.org.uk/visit/shropshire-staffordshire/carding-mill-valley-and-the-long-mynd).

### WENLOCK PRIORY

The picturesque remains of a medieval priory, built on the site of an Anglo-Saxon monastery, and also featuring a cloister garden, filled with topiary. Parking, toilets and picnic area on site, and dogs on leads welcome. Follow signs from Much Wenlock centre. Go to [www.english-heritage.org.uk/visit/places/wenlock-priory/](http://www.english-heritage.org.uk/visit/places/wenlock-priory/) for additional information.

### WENLOCK EDGE

Owned by the National Trust, this 18 mile escarpment offers two circular walks – the 3.5 mile Major's Leap walk and the gentler 2.2 miles Jenny Lind walk. Car parking available at Much Wenlock, Presthope and Wilderhope Manor. Free entry and dogs very welcome. Information at [www.nationaltrust.org.uk/wenlock-edge](http://www.nationaltrust.org.uk/wenlock-edge).

## LOCAL ATTRACTIONS

### SHROPSHIRE HILLS DISCOVERY CENTRE

On the A49 at Craven Arms, the Centre offers 30 acres of riverside meadows with accessible paths, a 'Shropshire Hills Through Time' exhibition (including a replica of the famous mammoth skeleton discovered in Condover), and a café. Admission free to the outside spaces and café, but there is a charge for entry to the exhibition. Dogs on leads welcome in outside areas. Information at [www.shropshirehillsdiscoverycentre.co.uk](http://www.shropshirehillsdiscoverycentre.co.uk).

### STOKESAY CASTLE

A 13th century fortified manor house with a fairy-tale tower to climb. Tearoom serving lunches and cakes with a view over the Shropshire countryside. For opening hours and admission prices please go to [www.english-heritage.org.uk/visit/places/stokesay-castle/](http://www.english-heritage.org.uk/visit/places/stokesay-castle/). Parking, picnic area and toilets available. Dogs on leads welcome in the grounds.

### QUARRY PARK, SHREWSBURY

Twenty-nine acres of parkland along the River Severn, offering opportunities for strolling, running, fishing and cycling. Also features the Dingle gardens, designed and cultivated by Percy Thrower. Dogs welcome on and off the lead. Handy parking at St Julians car park (parking charges apply). Public toilets available. A riverside path also runs from the Quarry towards the Monkmoor area of Shrewsbury and then on to Uffington.

### LYTH HILL COUNTRY PARK

Spectacular views of the Shropshire countryside from this site, which features open grassland and oak woodland. Popular with ramblers, joggers and dog walkers. Also forms part of a long-distance bridleway for horse riders. Two car parks available, accessed from Lyth Hill Road in Bayston Hill (postcode SY3 0BT). Free entry and open all year round.

### IRONBRIDGE GORGE MUSEUMS

Something for all the family, from living history at the Blists Hill Victorian Museum to examples of the best china of the era at Coalport China Museum. This collection of 10 museums, centred around the town of Ironbridge, offers an insight into different aspects of the Industrial Revolution. For information on the different museums, please take a look at [www.ironbridge.org.uk](http://www.ironbridge.org.uk).

### LOCAL WALKS

If you fancy a walk in the immediate neighbourhood, check out the Local Strolls featured in past editions of Village Views, courtesy of our local stroller, John Glover. Past copies of Village Views can be accessed from [www.actonburnellparishcouncil.org.uk/village-views](http://www.actonburnellparishcouncil.org.uk/village-views) – most editions include a walk for you to enjoy, complete with map, photos and handy information on the history, geology and wildlife of the area.

### CINEMAS AND THEATRES

Shrewsbury can offer both a multiplex cinema, Cineworld on Old Potts Way, Shrewsbury SY3 7ET, and a single screen cinema at The Old Market Hall, The Square, Shrewsbury SY1 1LH ([www.oldmarkethall.co.uk](http://www.oldmarkethall.co.uk)), which also has a café and bar on site. Shrewsbury is also the home of Theatre Severn at Frankwell Quay, Shrewsbury SY3 8FT ([www.theatresevern.co.uk](http://www.theatresevern.co.uk)), which features drama, comedy, music and dance performances throughout the year. Further afield, Telford has an Odeon Luxe in the Town Centre ([www.odeon.co.uk/cinemas/telford/](http://www.odeon.co.uk/cinemas/telford/)).

## HELP AND SUPPORT

### GENERAL SOURCES OF HELP AND SUPPORT

**Citizens Advice** (Advice and support across a wide range of issues

*Monday to Friday 10.00am to 4.00pm*)

Website: [www.cabshropshire.org.uk](http://www.cabshropshire.org.uk)

Telephone: **0808 278 7894** (calls free from landlines and mobiles)

**Red Cross** (Emotional support, links to local support services, wheelchair access and help when returning from hospital)

Website: [www.redcross.org.uk/get-help](http://www.redcross.org.uk/get-help)

Telephone for support and assistance: **0808 196 3651**

Telephone for general enquiries: **0344 871 11 11**

### MENTAL HEALTH AND WELLBEING:

**NHS Every Mind Matters**

Website: [www.nhs.uk/every-mind-matters/](http://www.nhs.uk/every-mind-matters/)

**Mental Health Social Work Team**

Website: [www.shropshire.gov.uk/disability-information/mental-health/](http://www.shropshire.gov.uk/disability-information/mental-health/)

Telephone: **01743 255895**

**Shropshire/Telford & Wrekin ACCESS service** (Available 24/7 to provide information, advice and guidance)

Telephone: **0808 196 4501**

**Shropshire Mental Health Support** (Offers a wide range of services for people affected by emotional and mental distress and their families, including those living in rural areas at risk of isolation)

Website: [www.shropshiremhs.com/about/](http://www.shropshiremhs.com/about/)

Telephone: **01743 368 647**

**Samaritans** (Telephone support 24 hours a day, 365 days a year)

Telephone: **116 123**

### FINANCIAL AND DEBT ADVICE

**Citizen's Advice Bureau** (Specialist debt team *Monday to Friday 10.00am to 4.00pm*)

Website: [www.cabshropshire.org.uk](http://www.cabshropshire.org.uk)

Telephone: **01743 280019**

**National Debtline** (Free, independent advice over the phone and via webchat)

Website: [www.nationaldebtline.org](http://www.nationaldebtline.org)

Telephone: **0808 808 4000**

**StepChange Debt Charity** (Free confidential advice on handling debt and financial issues)

Website: [www.stepchange.org](http://www.stepchange.org)

Telephone: **0800 138 1111**

## HELP AND SUPPORT

### FOOD BANKS

**Shropshire Larder** (Emergency food supplies for people in crisis (please note: a referral may be needed from a health professional, social worker, advice worker, housing association or Shropshire Council to access some services)

Website: [www.shropshirelarder.org.uk/emergencyfood](http://www.shropshirelarder.org.uk/emergencyfood)

**Food banks available at:**

**Church Stretton** (*Friday 2.30pm to 4.00pm*) No referral needed.

Telephone: **07561 693870**

**Shrewsbury, Hope Church**, Harlescott Grange (*Wednesdays 10.00am to 12.30pm*)

Telephone: **01743 272465**

**Shrewsbury, Barnabas Centre**, Longden Coleham

(*Monday, Tuesday and Friday 9.30am to 12.00pm*)

Telephone: **0742 174 5857**

### SPECIAL EDUCATIONAL NEEDS AND DISABILITIES

**Shropshire Special Educational Needs and Disabilities (SEND)** (Information on a range of issues and services relating to children and young people with additional or special needs and disabilities)

Website: [www.shropshire.gov.uk/the-send-local-offer/](http://www.shropshire.gov.uk/the-send-local-offer/)

Telephone: **0345 678 9063**

**Shropshire Council Special Educational Needs Team** (Point of contact for enquiries regarding provision for individual children.

Website: [www.shropshire.gov.uk/the-send-local-offer/education/education-services/special-educational-needs-sen-team/contact-the-sen-team/](http://www.shropshire.gov.uk/the-send-local-offer/education/education-services/special-educational-needs-sen-team/contact-the-sen-team/)

Telephone: **01743 254267**

Email: [senteam@shropshire.gov.uk](mailto:senteam@shropshire.gov.uk)

**Shropshire IASS (Information, Advice and Support Service)** (Independent information, advice and support to parents and carers of children aged 0 to 25, and young people aged 16 to 25 who have, or may have, special educational needs or disabilities (SEND)

Website: [www.cabshropshire.org.uk/shropshire-iass/](http://www.cabshropshire.org.uk/shropshire-iass/)

Telephone: **01743 280019**

### OLDER PEOPLE

**Age UK** (Information and support on a wide range of issues affecting older people)

Website: [www.ageuk.org.uk/shropshireandtelford/](http://www.ageuk.org.uk/shropshireandtelford/)

Telephone: **01743 233 123** for general enquiries

Telephone: **01743 233788** for their 'help at home' service

**Silverline** (Free 24 hour confidential helpline for older people)

Telephone: **0800 470 8090**

## HELP AND SUPPORT

### CLAIMING BENEFITS

**Shropshire Council** (Information on Council tax support, housing benefit and housing payments)

Website: [www.shropshire.gov.uk/benefits/](http://www.shropshire.gov.uk/benefits/)

Telephone: **0345 678 9002**

**Citizens Advice** (Information and advice on benefits.

*Monday to Friday 10.00am to 4.00pm*)

Website: [www.citizensadvice.org.uk/benefits/](http://www.citizensadvice.org.uk/benefits/)

Telephone: **0808 278 7894**

**Turn2Us** (An online benefit entitlement check or to search for grants)

Website: [www.turn2us.org.uk](http://www.turn2us.org.uk)

### ANIMAL WELFARE

#### RSPCA

Website: [www.rspca.org.uk/local/aboutus/contactus/-/rspca/shropshire-branch](http://www.rspca.org.uk/local/aboutus/contactus/-/rspca/shropshire-branch)

Telephone: **0300 1234 999** to report cruelty or an animal in distress

Telephone: **07703 567 935** all other enquiries

**Cats Protection** (Help and advice on all aspects of cat ownership)

Website: [www.cats.org.uk/about-cp](http://www.cats.org.uk/about-cp)

Telephone: **01584 878606**

**Shropshire Cat Rescue** (Cares for and rehomes unwanted cats and kittens)

Website: [www.shropshirecatrescue.org.uk](http://www.shropshirecatrescue.org.uk)

Telephone: **01743 872857**

**Dog's Trust** (Cares for and rehomes unwanted and abandoned dogs. Also provides help and advice on dog care and training)

Website: [www.dogstrust.org.uk/our-centres/shrewsbury/](http://www.dogstrust.org.uk/our-centres/shrewsbury/)

Telephone: **01952 770225**

**Grinhill Dog Rescue** (Family run rescue kennels for dogs and cats)

Telephone: **07740 103393**

**Cuan Wildlife Rescue** (Wildlife rescue centre, open 24 hours a day, 7 days a week)

Website: [www.cuanwildliferescue.org.uk/](http://www.cuanwildliferescue.org.uk/)

Telephone: **01952 728070**



# Your local fuel and heating oil specialist.



Gas Oil & Gas Oil+



Heating & AGA fuels



Lubricants & Additives



Fuel Tanks

For your first order or hundredth order, Rix are here for you.



Call **01952 684 600** or visit [www.rix.co.uk](http://www.rix.co.uk)







# SHROPSHIRE TURF

Turf | Soil | Bark | Compost | Seed

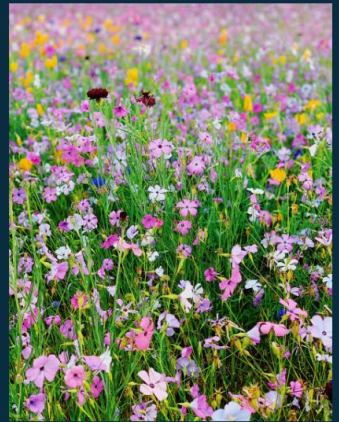

A leading provider of landscape materials with a reputation for providing quality products.

Call 01952 510386 or Visit [www.shropshireturf.com](http://www.shropshireturf.com)